

R162T60B

printed on: 09-06-2026



TECHNICAL INFO

Media type	WIRE MESH
Efficiency	60 µm
Flow direction	OUT-IN
Collapse Δp	10 bar
Bypass setting	1.7 bar
Seals	NBR
Temperature range	-30°C +100°C

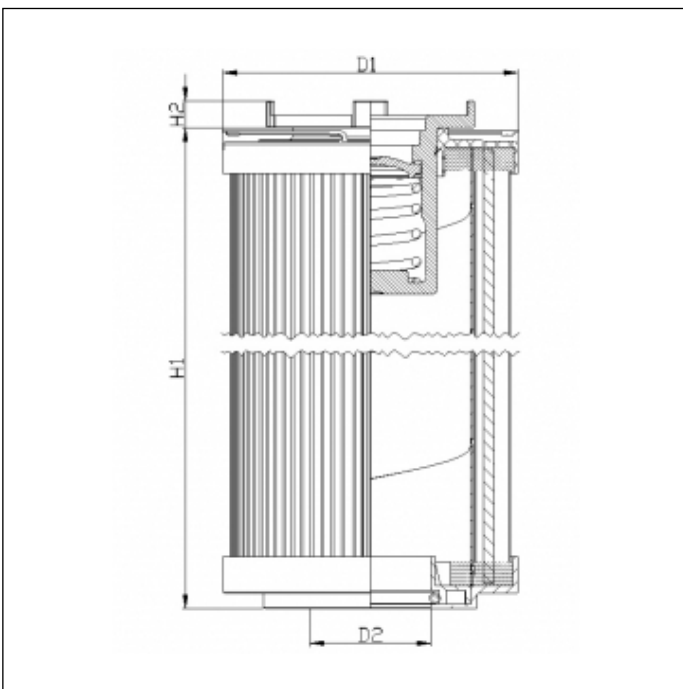

OVERALL DIMENSIONS

D1	130,0 mm
D2	64,5 mm
H1	141,0 mm
H2	9,0 mm

Technical information may change without notice. Image and drawing are representative only